

24VDC emergency power dimensions

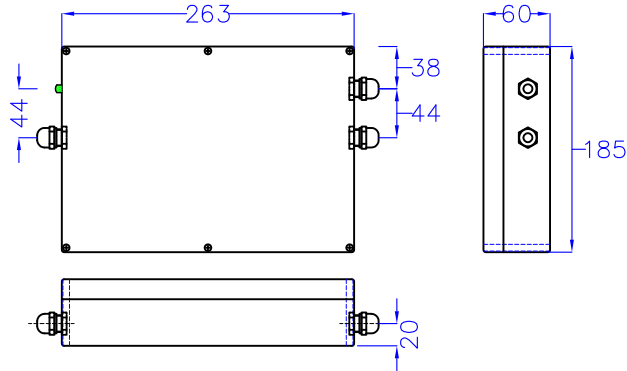

Wiring

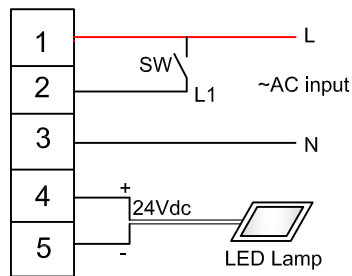

LED indicator Status:

| | |
|--|-------------------|
| | charging |
| | charging finished |
| | power off |

Specification

| | E2-24VDC-90M | E2-24VDC-180M | |
|-----------------------|--|---------------------|--|
| Input | 220-240VAC | 220-240VAC | |
| | 50/60Hz | 50/60Hz | |
| Output | 24VDC | 24VDC | |
| | 10W ~ 40W / 90mins | 10W ~ 40W / 180mins | |
| Emergency type | Maintained | | |
| Comment | Battery pack to be changed after 3 years | | |